

REWITNESSED CORNER FOR STATE OF OREGON - DEPARTMENT OF FORESTRY

One quarter corner common to Sections 14 and 23, T3N, R6W, W.M., Tillamook County, Oregon.

ORIGINAL

Post (missing) from which a:

42" fir bears S23½° W 60 lks.; now 44" stump, scribes ¼ S BT visible.

10" hemlock bears N60° E 22½ lks.; destroyed by road construction.

RESTORATION by Oregon State Forestry Department in 1954.

Found ¾" x 19" iron pin out of place. Set pin in place, 13" in ground, from which a:

8" fir bears N59° W 16.4 ft.; destroyed by road construction.

8" fir bears S73° E 26.1 ft.; now a standing rotten 10" snag with face visible.

REWITNESSED

VAR. 21½° E

Set 2" x 36" aluminum pipe with magnet with 3 ¾" aluminum cap marked "State of Oregon Department of Forestry T3NR6W ¼ S14 S23 1987 RS1662" over above mentioned pin, 34 inches in ground, and from which a:

22" fir bears S39 ¾° W 31.1 ft. to face; scribed ¼ S 23 BT.

20" fir bears N19½° W 49.0 ft. to face; scribed ¼ S 14 BT.

Rock road bears north 23.0 ft. crs.; N65° E by S65° W.

Set 4" x 4" x 72" white painted cedar post NW 1.0 ft. from corner pipe. Oregon State Forestry Department metal location poster on 22" fir BT S39 ¾° W 31.1'.

Dated April 16, 1987.

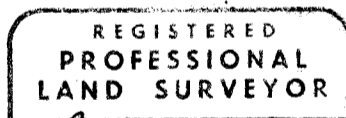

Loren R. Steele
OREGON
JULY 14, 1978
LOREN R. STEELE
1662

Present and witnessed by S. Ellis

BOOK 6

316